



**A/To:** All ASNs, FIA Medical Delegates  
**De/From:** Yvan DEVIGNE  
Safety Department

**Date:** Geneva, 31 March 2017

**Page(s):** 1+11

**Opening methods for helmet visors**

**Only for advanced helmets meeting FIA Standard 8860-2010**

Dear Sir or Madam,

This information note is in regards to full-face helmets which comply with FIA Standard 8860-2010 that are compulsory in several FIA Championships and International Series, such as Formula 1 and the WEC. Eight manufacturers were involved in providing the FIA with the below information.

During a medical intervention following an accident, one of the first key actions that needs to be done is to open the visor and check if the person is still conscious and breathing. Keeping the visor open helps to maintain communication with the victim, in order to obtain information and ensure he/she does not lose consciousness.

In this context, it is vital to be familiar with the various opening systems available on the market. The intention of this document is to provide all required information.

We remain at your disposal for any further information you may require.

Yvan DEVIGNE

Email: [ydevigne@fia.com](mailto:ydevigne@fia.com)

## ARAI

To open the shield, push up the shield lock release lever to release the lock system.

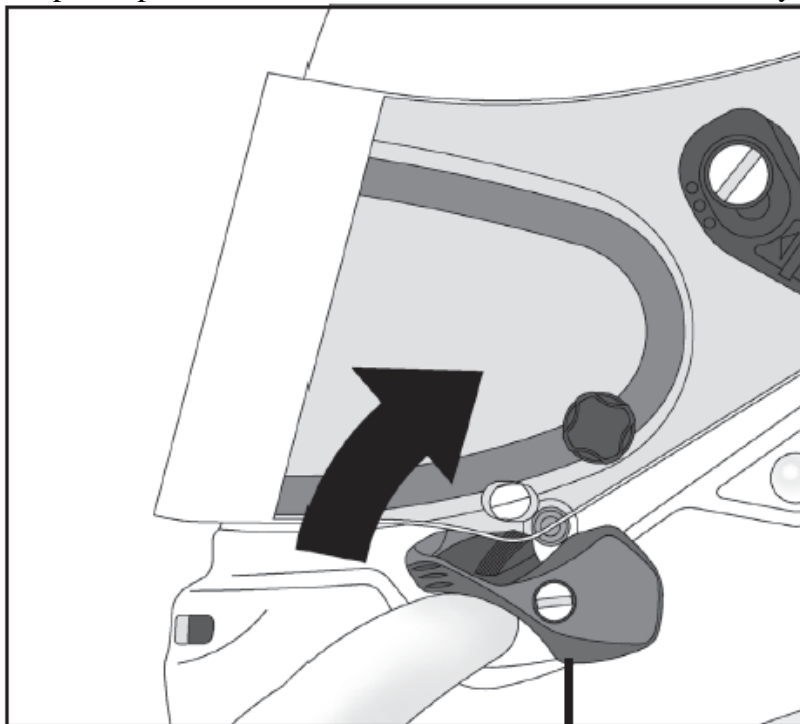

Shield Lock Release Lever

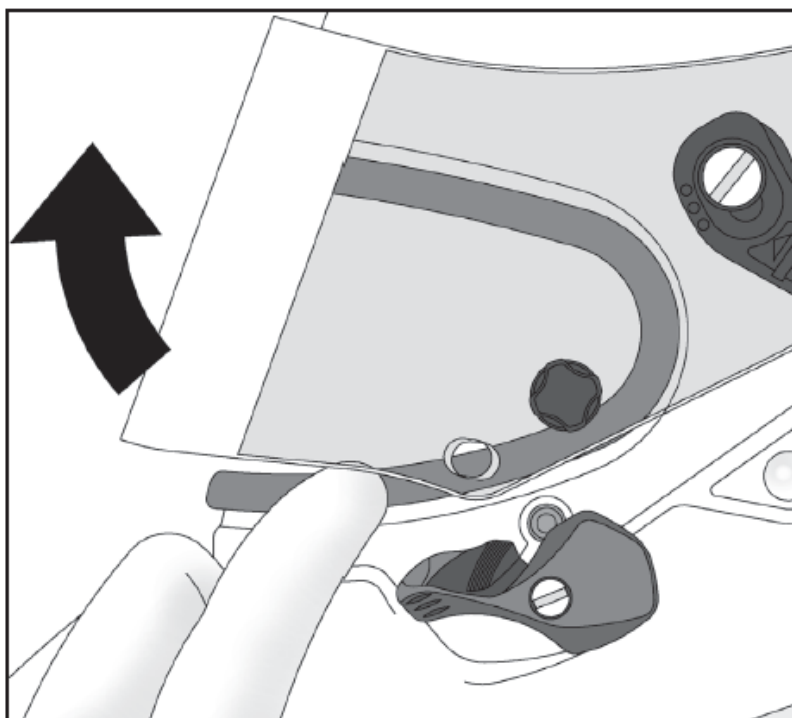

## BELL

1. Locate the shield thumb tab on the left side of the helmet.
2. Place your thumb underneath the tab.
3. **Using your thumb**, press **up and away** from the helmet to release the shield from the pin.
4. Raise the shield to the desired height.



## OMP Version 1

1. Locate the shield thumb tab on the left side of the helmet.
2. Place your thumb underneath the tab.
3. **Using your thumb**, press **up and away** from the helmet to release the shield from the pin.
4. Raise the shield to the desired height.





## OMP Version 2

Locate the black tab marked "OPEN".  
This tab slides to unlock the visor.



Put your finger on the plastic black tab,  
press and slide upwards to unlock, releasing the visor.



Then, use the tab on the left to pull up.



## SCHUBERTH



**1/ Put your index finger on the top of the lock.**

**2/ Put your thumb at the bottom.**

**3/ Pull the bottom of tab towards you to unlock.**

Do not use pointing finger to pull as thumb usually has more strength.

**4/ Lift the visor to the desired height.**

## SIMPSON

1/ Locate the shield thumb tab on the left side of the helmet.



2/ Place your thumb underneath the tab.



3/ **Using your thumb**, press up and away from the helmet to release the shield from the lock-down pin.

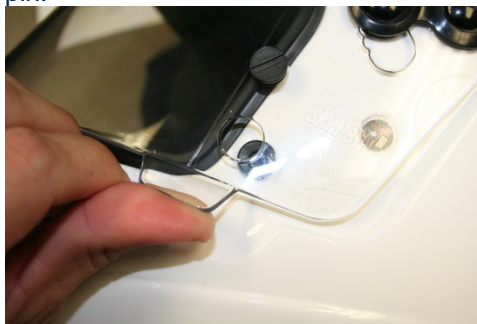

4/ Raise the shield to the desired height.





## STAND 21

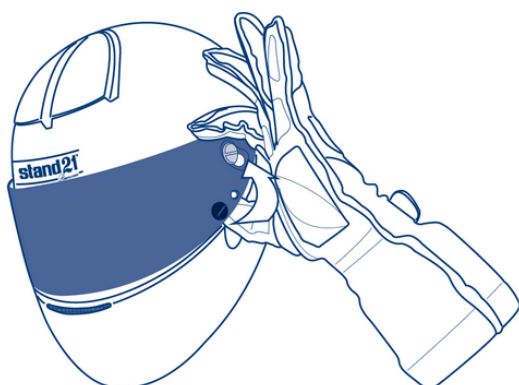

1. Locate the aperture on the right side of the helmet.



2. **Place your thumb** in the aperture.
3. Pull **outwards** to unlock from the pin lock.
4. Lift the visor slightly.



5. Then lift the visor all the way to the top.



## STILO Version 1





FEDERATION INTERNATIONALE DE L'AUTOMOBILE

## STILO Version 2



Chemin de Blandonnet 2  
1215 Geneva15, Switzerland  
T +41 22 544 44 00  
F +41 22 544 44 50

FIA.COM

A WORLD IN MOTION

## SPARCO (VM safety) Version 1

To open the visors:

1/ Press the black button shown in photo.

2/ Hold the tab with your fingers.

3/ Lift the visor up.



## SPARCO (VM safety) Version 2

To open the visors,  
pull the grey tab up in order to separate it from the lock on the helmet shell.  
Once the tab is free, lift the visor up.

